



Church View Church Lane, Marshchapel, DN36 5TW
£145,000

NO ONWARD CHAIN
READY TO MOVE IN

TES Property is delighted to offer for sale this charming mid-terraced country cottage located along a quiet village lane with garden views of the church in the popular and well serviced village of Marshchapel. This beautifully presented property is full of charm and style and benefits from a spacious dining kitchen, living room with direct access to an enclosed private rear garden, two double bedrooms and a first floor bathroom. The property also has the added bonus of recently having a new heating system put in along with a brand new combination boiler. If you are looking for a slice of traditional village life look no further. Viewing is highly recommended to appreciate all this cottage has to offer.

ENTRANCE PORCH



A wooden cottage style door leads into a welcoming porch area with a uPVC double glazed window to the front aspect tiled flooring and a useful storage cupboard.

DINING KITCHEN 15'1" x 10'00" (4.60m x 3.05m)



A spacious dining kitchen with ample space for a dining table, The kitchen area is fitted with a range of base units with work tops above, there is a white sink with mixer taps and a central heating radiator. Two uPVC windows face the front aspect and a latch door leads to the living room.

LIVING ROOM 15'2" x 10'00" (4.62m x 3.05m)



A charming living room with a bespoke part glazed stable door providing direct access to the rear garden. There is a useful under stair storage cupboard with a central heating radiator and a latch door leading to an open tread staircase.

FIRST FLOOR LANDING

with access to all first floor rooms.

BEDROOM 1 10'3" x 10'00" (3.12m x 3.05m)



Having a uPVC double glazed window to the front rear aspect and two fitted wardrobes to each side of the chimney breast, and an additional built in wardrobe and central heating radiator.

BEDROOM 2 9'11" x 7'11" (3.02m x 2.41m)



Having a central heating radiator with wooden radiator cover and uPVC double glazed window to the front aspect with views of the church.

BATHROOM 6'11" x 6'10" (2.11m x 2.08m)



Fitted with a three piece white suite comprising a panel bath with mixer taps and shower head attachment, a W.C and a wash basin, the walls are part tiled and there is a uPVC frosted window.

FRONT GARDEN

The front of the property enjoys open plan front lawn with a small patio area and a fish pond and a selection of mature shrubs and trees. There is right of way across the neighboring property to an access leading onto Church Lane.

REAR GARDEN



The rear of the property is fully enclosed and mainly laid to lawn with flower and shrub borders. A paved patio area provides an ideal space for private alfresco dining.

VIEW OF THE CHURCH



The front of the property enjoys a magnificent view of the church.

Services

Mains water, drainage and electricity are understood to be connected along with oil fired central heating. The agents have not tested or inspected the services or service installations and buyers should rely on their own survey.

Tenure

The property is freehold.

Council Tax Band

East Lindsey Council Tax Band A

Brochure Prepared

July 2023

Viewings

By prior appointment through TES Property office in Louth
01507 601633 admin.louth@tes-property.co.uk

Opening Hours

Monday to Friday 9:00am to 5:00pm
Saturday 9:00am to 1:00pm

Floor Plan

GROUND FLOOR

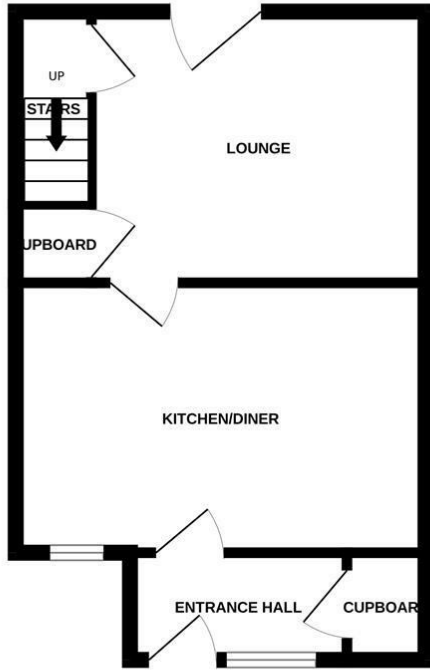

1ST FLOOR

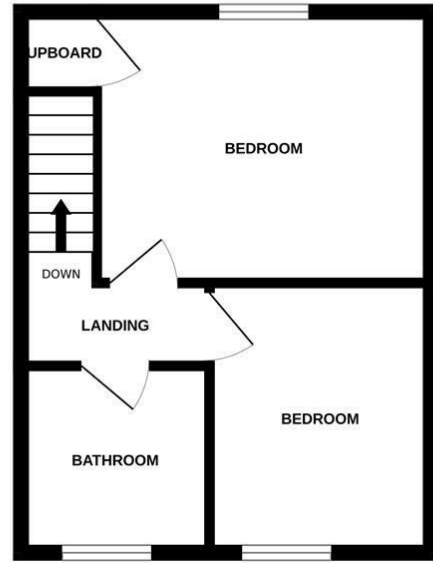

Whilst every attempt has been made to ensure the accuracy of the floorplan contained here, measurements of doors, windows, rooms and any other items are approximate and no responsibility is taken for any error, omission or mis-statement. This plan is for illustrative purposes only and should be used as such by any prospective purchaser. The services, systems and appliances shown have not been tested and no guarantee as to their operability or efficiency can be given.
Made with Metropix ©2023

Area Map



Energy Efficiency Graph

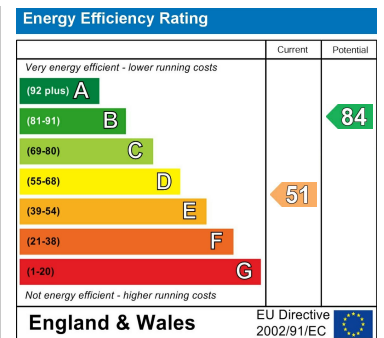

These particulars, whilst believed to be accurate are set out as a general outline only for guidance and do not constitute any part of an offer or contract. Intending purchasers should not rely on them as statements of representation of fact, but must satisfy themselves by inspection or otherwise as to their accuracy. No person in this firm's employment has the authority to make or give any representation or warranty in respect of the property.