

wilko

20L microwave

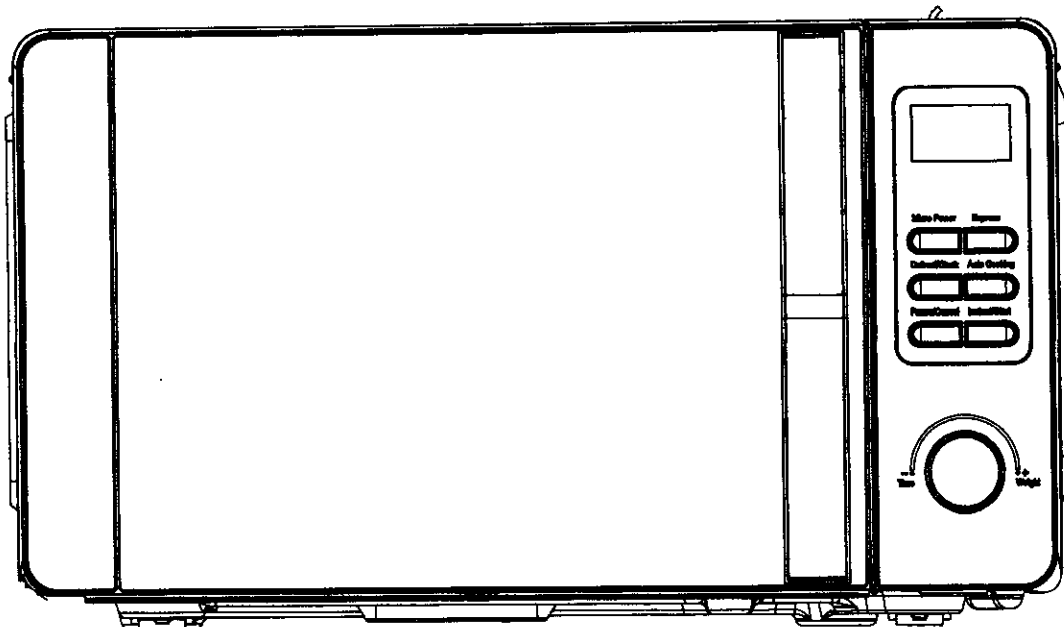

800
watt

output
power

20
Ltr

capacity

Please read these instructions carefully and keep for future reference.

Specifications

Rated voltage: 220-240V~

Operating frequency: 50Hz

Microwave input power: 1150-1280W

Microwave output power: 700- 800W

Outside Dimensions: L451 x W354x H256mm

Oven capacity dimensions: L296x W295 x H212 mm

Oven capacity: 20L

Weight: approx: 10.8 kg

Important Safety Instruction

Read these instructions carefully. Retain the instruction manual and installation instructions for future reference.

- The microwave oven is intended for heating food and beverages only. Drying food or clothing / heating warming pads, slippers, sponges, damp cloth and the similar may lead to risk of injury and ignition of fire, therefore should be avoided.

To reduce the risk of fire in the oven cavity:

- Do not overcook the food.
- Remove wire twist-ties from paper or plastic bags before placing bags in the oven. Only microwave safe paper/ plastic bags shall be used.
- Do not heat oil or fat for deep frying as the temperature of oil cannot be controlled.
- The oven should be cleaned regularly and any food deposits removed. Wipe the waveguide cover with a damp cloth, followed by dry cloth to remove any food splashes and grease. Built-up grease may overheat and begin to cause smoke or catch fire.
- Do not store any objects other than oven accessories inside the oven.
- Only use utensils that are suitable for use in microwave ovens.
- Close supervision is necessary when using disposable containers made from plastic, paper or other combustible material.
- When heating food or drink in plastic or paper containers, keep an eye on the oven due to possibility of ignition.
- Do not operate the oven empty. This will damage the appliance.

- The appliance is not intended to be operated by means of an external timer or separate remote-control system.
- If smoke is emitted, switch off or unplug the appliance and keep the door closed in order to stifle any flames.

To reduce the risk of explosion and scalding:

- **Warning:** Liquids and foods must not be heated in sealed container since they are liable to explode. Baby bottles fitted with screw caps or teats are considered to be sealed containers.
- Microwave heating of liquid can result in delayed eruptive boiling. Use wide mouthed container and leave it to stand about 20 seconds at the end of cooking.
- Do not cook eggs in their shells or reheat hard-boiled eggs since they may explode, even after microwave heating has ended.
- Foods with peel or skin may burst or explode during, or even after, heating. Potatoes, sausages and chestnuts should be peeled or pierced before cooking.
- Do not use plastic containers when heating or cooking foods that contain large amounts of fat or sugar.
- Slowly lift the furthest edge of dish cover and microwave plastic wrap ; carefully open popcorn and oven cooking bags away from face. Hot steam spontaneously escaped from the heated dish can cause serious scalding.
- Hot steam may escape when the oven door opens. Open the door with care.

To reduce the risk of burn:

- The container gets very hot after cooking. Always use oven gloves to remove it from compartment.

- Make sure the utensils do not touch the interior walls during cooking.
- Food heated in feeding bottles and baby food jars are to be stirred or shaken and the temperature is to be checked before consumption.
- **Warning:** Accessible parts may become hot during use. Young children should be kept away. Care should be always taken to avoid touching parts inside the compartment.

To reduce the risk of serious damage to health:

- Details for cleaning door seals, cavities and adjacent parts refer to **Care and Cleaning**.
- Failure to maintain the oven in a clean condition could lead to deterioration of the surface that could adversely affect the life of the appliance and possibly result in a hazardous situation.
- **Warning:** If the door or door seals are damaged, the oven must not be operated until it has been repaired by a competent person. The door seals are located around the window on the inside of the door. These seals are not airtight, although no microwaves can be released, it is normal for small amount of air or steam to escape when the oven is in use.
- **Warning:** It is hazardous for anyone other than a competent person to carry out any service or repair operation that involves the removal of a cover which gives protection against exposure to microwave energy.

To reduce the risk of electric shock:

- Only use this appliance indoors.
- If the supply cord is damaged, it must be replaced by the manufacturer or its service agent or a qualified technician.

To reduce the risk of injury:

- Any accessories not recommended by the manufacturer may cause injury to person.
- Allow the glass turntable to cool down before cleaning.
- Do not place hot foods or utensils on the cold turntable.
- Do not place frozen foods or utensils on the hot turntable.
- Do not use harsh abrasive cleaners or sharp metal scrapers to clean the oven door glass since they may scratch the surface, which may result in shattering of the glass.

This appliance is intended to be used in household and similar applications such as:

- Staff kitchen areas in shops, offices and other working environments;
- Farm houses;
- By clients in hotels, motels and other residential type environments;
- Bed and breakfast type environments.

This appliance should be used by children aged from 8 years and above and persons with reduced physical, sensory or mental capabilities or lack of experience and knowledge only if they have been given supervision or instruction concerning use of the appliance in a safe way and understand the hazards involved. Children shall not play with the appliance. Cleaning and user maintenance shall not be made by children without supervision. Keep the appliance and its cord out of reach of children less than 8 years.

Installation of Microwave Oven

1. Remove the packaging, some microwave ovens may have a blue film on the outer casing, if so, please remove this.
2. Install the distance limiter at the back of the enclosure, some microwave ovens may have this pre-installed. The distance limiter is to ensure sufficient clearance to the back and the adjacent walls for ventilation.
3. Check the oven after unpacking for any visual damage such as:
 - A misaligned door
 - Door or door seals damage
 - Dents, crack or holes in the door window or screen
 - Dents inside
 - Power cord damageIf any of the above is found, do not use the oven. Contact your nearest service centre.
4. Centre the roller ring in the oven compartment, and fit the glass turntable on top with care.

5. Microwave oven must be placed in dry and non-corrosive environments, kept away from heat and humidity, such as gas burner or water tank.
6. To ensure sufficient ventilation, the clearance to the back and any adjacent walls of the microwave should be a minimum of 10cm. One side of the microwave oven must be open and leave a minimum of 30cm clearance above the microwave oven.
7. The microwave oven must not be placed in a cabinet or cupboard. The microwave oven is intended to be used on table tops / freestanding.
8. Do not place any objects on top of microwave oven.
9. The appliance should be operated with the rear side facing the wall.
10. Place the oven as far away from radio, TV and antenna as possible. Using the oven may cause interference with the reception.
11. The appliance must be positioned so that the plug is accessible.
12. Plug the oven in a suitable 13amp mains socket; make sure the voltage is the same as the rating label (do not use extension cords or mains socket adaptors).
13. There may be some manufacturing residue or lubricants in the oven cavity or heating element, which may smell or even produce slight smoke. It is normal and would cease after several times of use. Keep doors and windows opened to ensure good ventilation. To clear the malodour, it is recommended to put a cup of water on the turntable and operate in high power for few minutes.

14. Never remove any parts from the oven such as feet or screws.

Warning: Do not place any objects on top of the microwave oven. Vent holes must not be obstructed at all times.

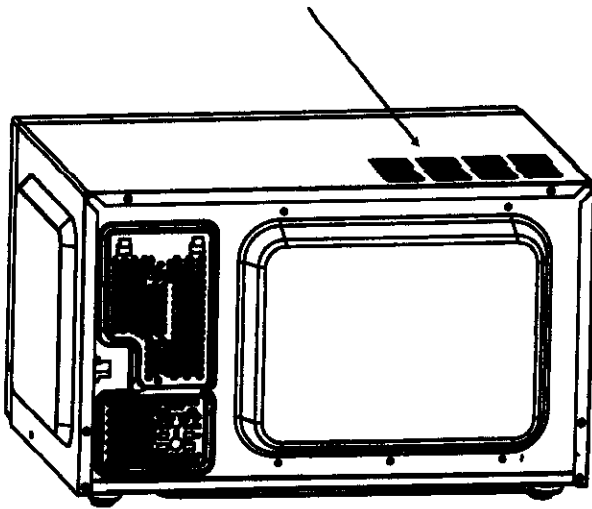

Warning: This appliance must be earthed

This appliance is designed to operate from a mains supply of AC220-240V ~ 50Hz. Check that the voltage marked on the product corresponds with your supply voltage.

This product is fitted with a 13A plug complying with BS1363.

Non-rewirable mains plug

This microwave is supplied with a non-rewirable plug incorporated with a fuse, the value of which is indicated either on the base of the plug or on the fuse carrier.

Should the fuse needs replacing, you must use an ASTA approved fuse (conforming to BS1362) of the same rating. If the fuse cover is lost the plug must not be used until a replacement is obtained from an electrical supplier. If you need to remove the plug, cut it from the mains lead and dispose of it. Never attempt to re-use this plug or insert it into a socket outlet, as there is a very great risk of an electric shock.

Utensils guideline

It is strongly recommended to use the containers which are suitable and safe for microwave cooking. Generally speaking, the containers which are made of heat-resistant ceramic, glass or plastic are suitable for microwave cooking. Never use metal containers for microwave cooking and combination cooking as spark is likely to occur. You can take the reference of below table.

Material of container	Microwave	Note
Ceramic	✓	Never use ceramic which are decorated with metal rim or glazed
Heat-resistant plastic	✓	Cannot be used for long time microwave cooking
Heat-resistant glass	✓	
Grill rack	✗	
Plastic film	✓	It should not be used when cooking meat or chops as the high temperature may damage the film
Bamboo, wood and paper	✗	Poor heat-resistant. Cannot be used for high temperature cooking

Structure diagram

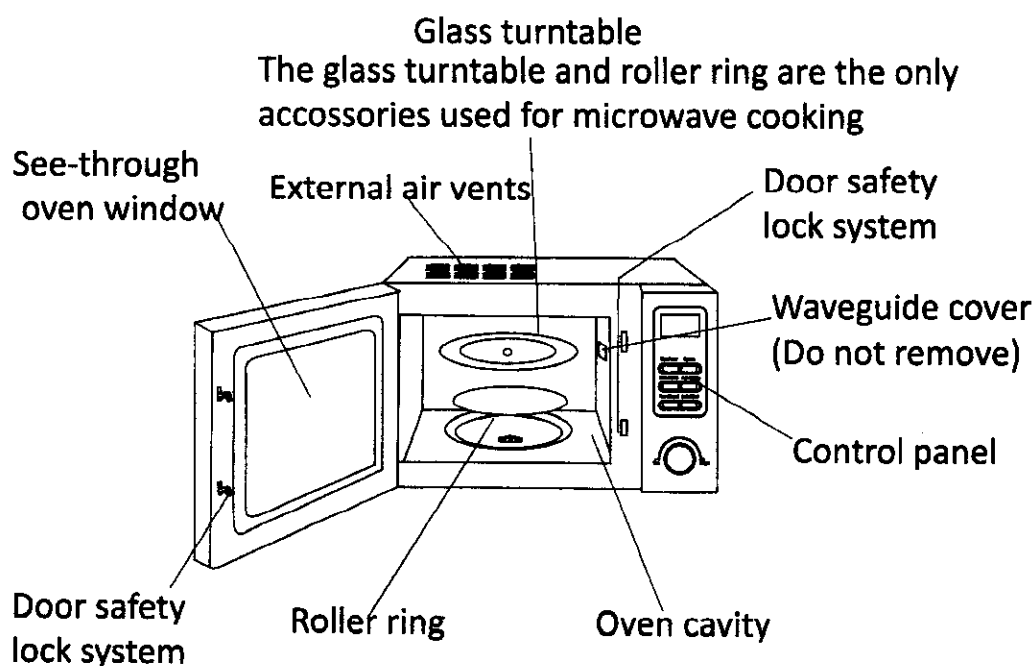

Warning: Do not remove the waveguide cover during cleaning. Make sure the waveguide cover installed properly and intact.

Control panel

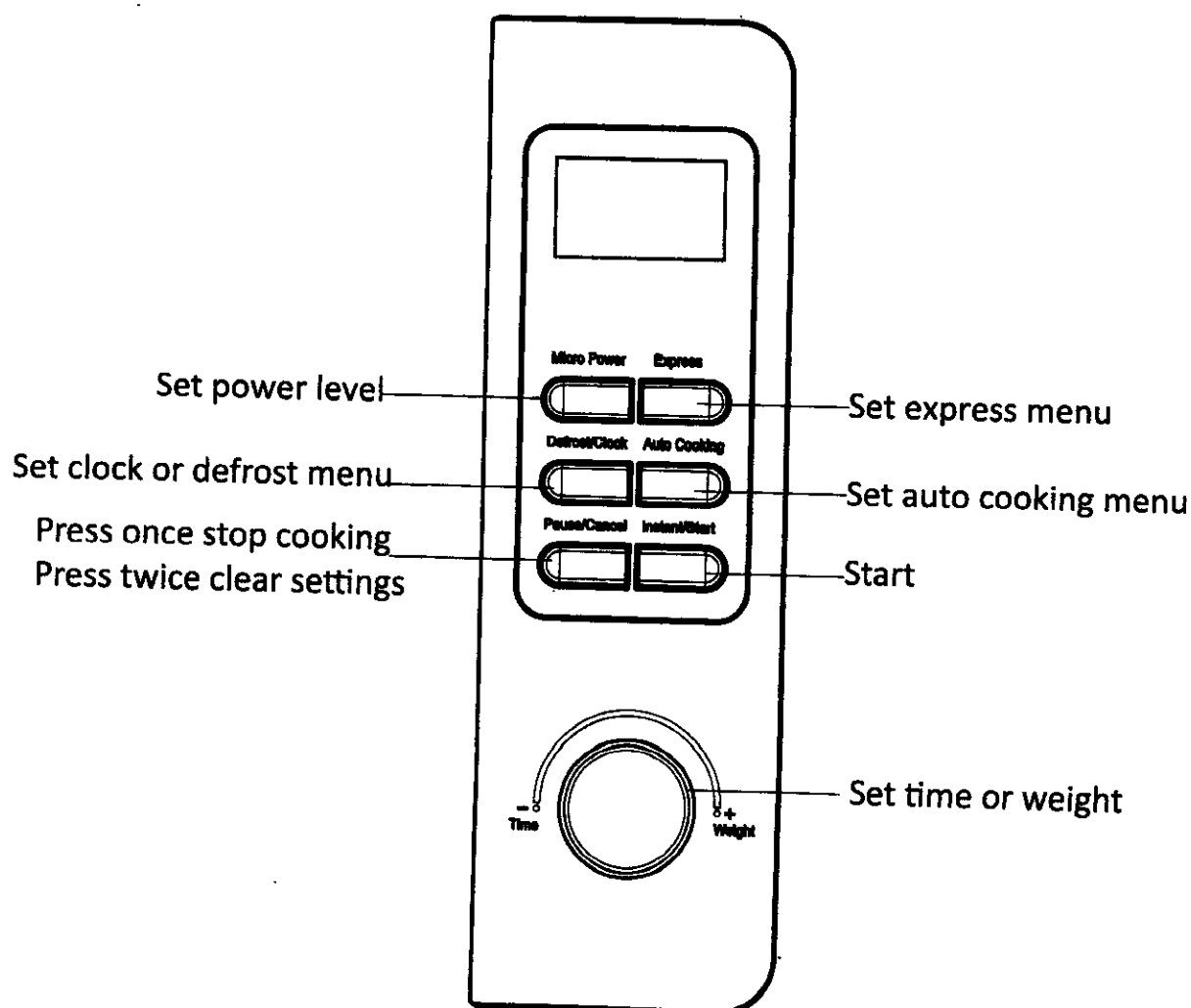

First use of microwave oven

There may be some manufacturing residue or lubricants in the oven cavity or heating element, which may smell or even produce a slight smoke. It is normal and would cease after several times of use. Keep a door or window open to ensure good ventilation. It is strongly recommended to place a cup of water on the turntable and operate in high power for few minutes.

Function and operation method

The LED flashes 3 times when plugged in mains socket. Then ":" flashes prompting you to input the cooking menu and time.

Auto reminder

When microwave operation has finished, the LED display will show **End** and three beeps sound prompting you to remove your food. If **Pause/Cancel** button was not pressed or door was not opened, beep sound at a 3 minutes interval.

Clock setting

Please see below steps to set the time on the display

For example: to set 12:30		
	Steps	Display
1	After power-up, the colon flashes.	1:00
2	Press and hold Defrost/Clock button for 3 seconds.	1:00
3	Turn Time/Weight knob to set exact hours.	12:00
4	Press Defrost/Clock button once again.	12:00
5	Turn Time/Weight knob to set exact minutes.	12:30
6	Press Defrost/Clock button once again or wait for 60 seconds, and the numbers will go steadily.	

Microwave cooking

To cook/heat food, press **Micro Power** button, the follow LED cycles will be displayed, 100P – 80P – 60P – 40P – 20P

High power	100P-100% microwave power. Applicable for quick and thorough cooking
Medium High power	80P-80% microwave power. Applicable for medium express cooking
Medium power	60P-60% microwave power. Applicable for steaming food
Medium Low power	40P-40% microwave power. Applicable for defrosting food
Low power	20P-20% microwave power. Applicable for keeping warm

NOTE:

- The maximum time can be set is 60 minutes.
- Never operate the oven empty.

- If you pause the operation open door to stir/turn food, press **Instant/Start** button once after door close and cooking will continue.
- To terminate operation, press **Pause/Cancel** once to stop cooking, press again to clear setting.

For example: to cook at P80 for 10 minutes		
		Display
1	Select the desired microwave power by pressing Micro Power button consecutively.	80P
2	Set cooking time by turning Time/Weight knob.	10:00
3	Press Instant/Start button and LED will count down to show running time.	

Express

Press **Express** button LED display will cycle to show 0:30, 1:00, 1:30.

This function will allow you to heat a cup of water or beverage conveniently, omitting the steps of setting time. Choose the proper time depending on the beverage capacity.

For example: to cook with express for 1 minute		
		Display
1	Press Express button consecutively to select desired menu.	1:00
2	Start cooking by pressing Instant/ Start button.	

Defrost

To defrost food, press **Defrost/Clock** button and the LED display will show d.1-d.2-d.3.

d.1	For defrosting meat, the weight range from 0.1 to 2.0 kg.
d.2	For defrosting poultry, the weight range from 0.2 to 3.0kg.
d.3	For defrosting seafood, the weight range from 0.1 to 0.9kg.

IMPORTANT

- It is necessary to turn over the food during operation to obtain uniform effect.
- Usually defrosting will need longer time than that of cooking the food.
- If the food can be cut by knife, the defrosting process can be considered completed.
- Microwave penetrates around 4cm into most food.
- Defrosted food should be consumed as soon as possible, it is not advised to put back to fridge and freeze again.

For example: to defrost 0.4kg poultry		
		Display
1	Press Defrost/Clock button to consecutively set the food kind.	d.2
2	Turn Time/Weight knob to set defrost weight.	0.4
3	Press Instant/Start to begin defrost.	
4	In half way during defrosting 3 short, consecutive beeping will sound twice to prompt you turn over the food. Press Pause/Cancel button. Open the door and turn over the food. Close the door, press Instant/Start button once to continue defrosting.	

Auto cooking programs

The oven has default cooking programs for simple operation. When the colon LED is flashing, press **Auto cooking** and LED will show A.1 through A.8. Choose the appropriate program according to the food type and weight. Strictly observe the directions in below table, otherwise the cooking effect will be largely influenced.

Display	Kind	Method
A.1	Popcorn	Suitable for popping a bag of corn, which is available in the market, weighted 0.1kg.
A.2	Reheat	Reheat food weighted 0.2-1.0kg.
A.3	Beverage	Heating 1-3 cup of liquid. The liquid temperature is about 5-10°C. Use a big mouth cup and do not seal
A.4	Pizza	Warm 1-2 pieces of chilled pizza.
A.5	Potato	Cooking the potato strips, cut into 5mm width and height, length. Total weight is about 0.45 or 0.65kg. Place the strips on a large dish and cover the dish with a thin film to prevent water loss.
A.6	Vegetable	Five weight options are available. (0.1, 0.2-----0.5Kg)
A.7	Meat	Five weight options are available. (0.1, 0.2-----0.5Kg)
A.8	Fish	Five weight options are available. (0.1, 0.2-----0.5Kg)

CAUTION

- The temperature of food before cooking would be 20-25°C.
Higher or lower temperature of the food before cooking would require increase or decrease of cooking time.
- The temperature, weight and shape of food will largely influence the cooking effect. If any deviation has been found to the factor noted in above

menu, you can adjust the cooking time for best result.

For example: Steam 0.5 kg fish		
		Display
1	Press Auto Cooking button to set the cooking menu.	A.8
2	Turn Time/Weight knob to set the set weight.	0.5
3	Start cooking by pressing Instant/Start button, and LED will count down to show running time.	

Delay starting

If you do not want cooking start immediately, you can set the cooking program and starting time. Cooking will start automatically at your preset time.

For example: Now it is 12:30 clock, if you hope that the microwave oven will automatically start cooking with 100P microwave power for 9 minutes and 30 seconds at 14:20		
		Display
1	Set the cooking menu and time.	
1.1	Select cooking power by pressing Micro Power button.	100P
1.2	Turn Time/Weight knob to set cooking time.	9:30
1.3	Press and hold Defrost/Clock button for 3 seconds to return to current clock.	
2	Set the time you expect to start cooking.	
3	Press Defrost/Clock button to confirm the delayed menu. Now the program has been activated and the clock symbol will be flashed. And the menu will be started at 14:20.	
4	You may check the preset starting time by pressing Defrost/Clock button.	

Caution:

- **Micro Power, Defrost/Clock, Express, Auto Cooking and Instant/Start** buttons are inactivated after setting Delay starting function. Press **Pause/Cancel** to cancel Delay starting function.

Sequential cooking

To obtain best cooking result, some recipes require different cooking programs and times. You may set your personalized program as follow:

For example: You want to cook food with 100P microwave power for 3 minutes, and follow by 20P for 9 minutes. This is a 2-sequence program.		
		Display
1	100P microwave power for 3 minutes.	
1.1	Press Micro Power button to select cooking power.	100P
1.2	Turn Time/Weight knob to set cooking time.	3:00
2	20P for 9 minutes.	
2.1	Press Micro Power button to select cooking power.	20P
2.2	Turn Time/Weight knob to set cooking time.	9:00
3	Press Instant/Start button to start sequential cooking.	

Caution:

- When first stage cooking is finished, microwave oven will begin next stage cooking automatically.
- Maximum 4 programs in a sequence can be set each time.

Child lock function

To activate the child lock function press and hold **Pause/Cancel** button for 3 seconds. The LED display will turn off. To deactivate (unlock), press and hold **Pause/Cancel** button for 3 seconds.

Cooking tips

1. The following factors may affect the cooking result:

Food arrangement

- Place thicker area towards outside of dish, the thinner part towards the centre and spread it evenly. Do not overlap if possible.

Cooking time length

- Start cooking with a short time setting, evaluate after it times out and extend it according to the actual need. Over cooking may result in smoke and burns.

Cooking food evenly

- Food such as chicken, hamburger or steak should be turned once during cooking.
- Depending on the type of food, if applicable, stir it from outside to centre of dish once or twice during cooking.

Allow standing time

- After cooking times out, leave the food in the oven for a adequate length of time, this allows it to complete its cooking cycle and cooling it down in a gradual manner.

2. Appearance of food help to determine whether the food is done, these include:

- Steam coming out from all parts of food, not just from the edge;
- Joints of poultry can be moved easily;
- Port of poultry shows no sign of blood;
- Fish is opaque and can be sliced easily with a fork.

3. Browning dish

When using a browning dish or self-heating container, always place a heat-

resistant insulator such as porcelain plate under it to prevent damage to the turntable and rotating ring.

4. Microwave safe plastic wrap

When cooking food with high fat content, do not allow the plastic wrap come into contact with food as it may melt.

5. Microwave safe plastic utensil

Some microwave safe plastic utensil might not suit for cooking foods with high fat and sugar content. And the cooking/heating time specified in the dish instruction must not be exceeded.

Care and cleaning

The oven should be cleaned regularly and any food deposits removed. Failure to maintain the oven in a clean condition could lead to deterioration of the surface that could adversely affect the life of the appliance and possibly result in a hazardous situation.

Read the safety guidelines in this manual before cleaning.

Switch the oven off before cleaning and unplug at socket if possible.

Use a slightly damp cloth to wipe the internal and external surfaces.

Open the door; remove the turntable and rotation ring. Rinse them under warm water and remove food deposits.

Do not remove the waveguide cover.

Do not use harsh detergent, gasoline, abrasive powder or metal brush to clean any part of the appliance.

Do not immerse the appliance in water or other fluids.

When the microwave oven has been used for a long time, some strange odours may exist in oven. Follow these simple guidelines to help remove the odours.

1. Place several lemon slices in a bowl with plenty of water, place in the oven and heat with high power for 2-3 minutes.

2. Put some orange peel on a plate, place in the oven and heat on high power for 1 minute.

Servicing

Before calling the hotline, please place a cup of water (approximate 150ml) in a glass container in the oven and close the door securely. Oven lamp should go off if the door is closed properly. Let the oven works for 1 minute.

- Does the oven lamp light?
- Does the cooling fan work? (Put your hand over the rear ventilation holes)
- Does the turntable rotate? (Turntable can rotate clockwise and counter clockwise)
- Does the water get hot?

If any answer "NO" of the above questions, please check whether the rotation ring and turntable are positioning correctly. And check the wall socket and plug fuse whether they are functioning properly. If not, please contact the nearest service centre approved.

Warning: MICROWAVE RADIATION!

Warning: It is hazardous for anyone, other than a qualified service technician, to carry out any service for repairing operation which involves removal of any cover which gives protection against exposure to microwave energy.

Warning: The temperature of accessible surfaces may be high when the appliance is operating or after operated.

Warning: the high voltage capacitor remains charge after disconnection; short the negative terminal of High voltage capacitor to the oven chassis (use a screwdriver) to discharge before touching. -

Warning: During servicing below listed parts are liable to be removed and give access to potentials above 250V to earth.

1. Magnetron
2. High voltage transformer
3. High voltage capacitor

4. High voltage diode
5. High voltage fuse

Warning: The following conditions may cause undue microwave exposure during servicing.

1. Improper fitting of magnetron;
2. Improper matching of door interlock, door hinge and door;
3. Improper fitting of switch support;
4. Door, door seal or enclosure has been damaged.

Environment



This product is covered by the Waste Electrical and Electronic Equipment (WEEE) Regulations. It should not be discarded with normal household waste, but taken to your local collection centre for recycling. For further information, please contact your local authority or retailer.



Now for the serious stuff.
Proof of purchase required.
All of this is in addition to your statutory rights.

Produced in China for Wilko, Roebuck Way,
Manton Wood, Worksop, Nottinghamshire, S80 3EG
Careline 08000 329 329 wilko.com