

ESSENTIALS

Bagless Cylinder Vacuum Cleaner

Instruction Manual

C700VC18



Contents

Safety Warnings.....	4
Unpacking.....	6
Product Overview.....	7
Preparation Before Use	8
Operation	9
Powering Off and Storage.....	10
Emptying the Dust Bin	11
Cleaning the Filters in the Dust Container	12
Cleaning the Exhaust Filter	12
Specifications.....	13

Safety Warnings

For your continued safety and to reduce the risk of injury or electric shock, please follow all the safety precautions listed below.

- Read all the instructions carefully before using the appliance and keep them for future reference.
- Retain the manual. If you pass the appliance onto a third party make sure to include this manual.
- Check that the voltage marked on the rating label matches your mains voltage.
- Consult your dealer if you are ever in doubt about the installation, operation or safety of your appliance.
- Do not remove any fixed cover as this may expose dangerous voltages.
- Do not allow any electrical appliance to be exposed to dripping or splashing.
- To protect against electrical shock, do not immerse the mains cable, mains plug, or any part of the appliance in water or other liquids.
- Make sure the dust bag is properly installed before use.
- Never vacuum up water or any other liquids. Never vacuum up flammable substances and do not vacuum up ashes until they are cold.
- Never use the appliance without the motor protection filter. Without this, the motor will be damaged and the life of the appliance will be shortened.
- If a blockage is found in the brushes, hoses or tubes, it should be removed before use.
- Store and use the appliance well away from heat sources such as radiators or gas / electric fires.
- Do not run over the mains cable with the appliance.
- Close supervision is necessary when any appliance is used by or near children.
- This appliance can be used by children aged from 8 years and above and persons with reduced physical, sensory or mental capabilities or lack of experience and knowledge if they have been given supervision or instruction concerning use of the appliance in a safe way and understand the hazards involved. Children shall not play with the appliance. Cleaning and user maintenance shall not be made by children without supervised.
- Keep the appliance and its cord out of reach of children less than 8 years.
- Children should be supervised to ensure that they do not play with the appliance.
- Do not point the hose, tube or any other accessory at the eyes, ears or mouth during operation.
- Unplug the appliance from the mains socket when it is not in use and before replacing the dustbag or filter.
- Allow the appliance to cool completely before cleaning or storing.

- Do not use the appliance for other uses than its intended use.
- The use of accessories not recommended by the appliance manufacturer may cause injury.
- Do not use the appliance outdoors.
- Do not operate an appliance with a damaged mains cable or mains plug, or in an abnormal state. If the mains cable is damaged it must be replaced by the manufacturer, its service agent, or similarly qualified persons in order to avoid a hazard.
- Do not continue to operate the appliance if you are in any doubt about it working normally (e.g. abnormal noise, smell, smoke), or if it is damaged in any way - switch off, withdraw the mains plug and consult your dealer.
- Any maintenance and repair must be handled by a professional technician. Do not try to repair by yourself.
- This appliance is designed for indoor, household use only.
- Make sure the unit is earthed properly during use. Use of any extension sockets must have an earth connection. If in doubt, contact a qualified electrician.

Thank you for purchasing your new product.

We recommend that you spend some time reading this instruction manual in order that you fully understand all the operational features it offers. You will also find some hints and tips to help you resolve any issues.

Read all the safety instructions carefully before use and keep this instruction manual for future reference.

Unpacking

Remove all items from the packaging. Retain the packaging. If you dispose of it please do so according to local regulations.

The following items are included:

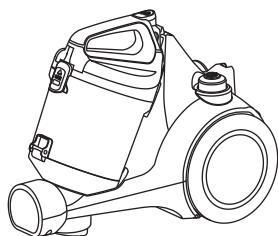

Main Unit

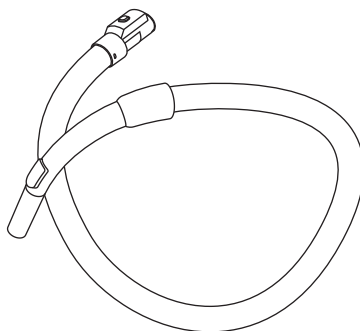

Hose

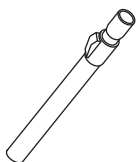

Extension Tube

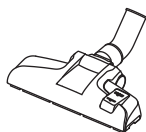

Floor Brush



Combination
Nozzle

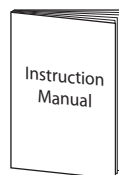

Instruction Manual

Product Overview

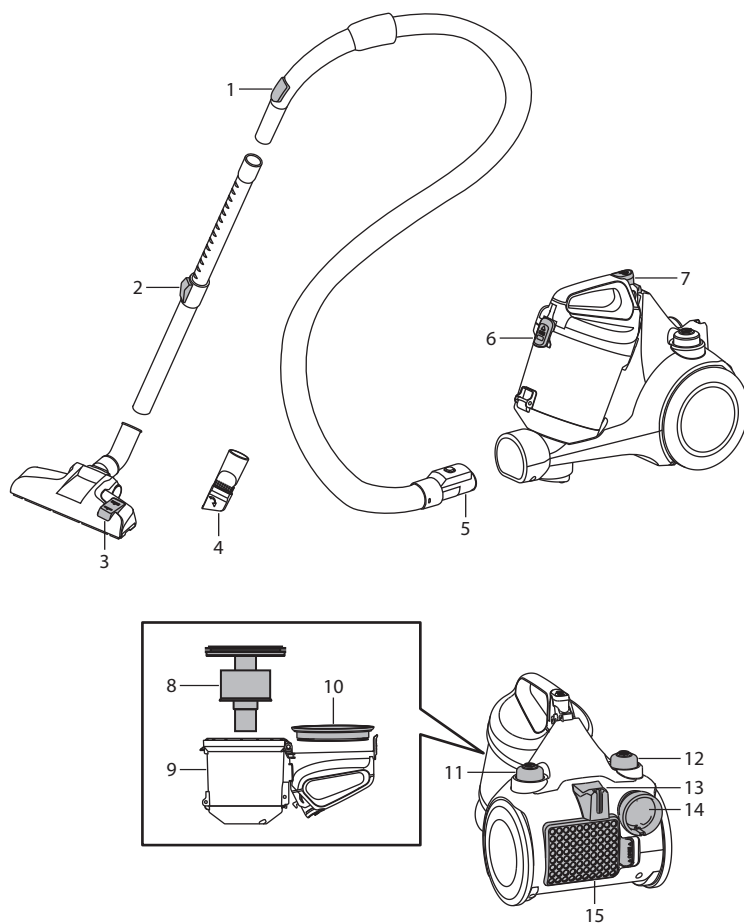

- 1. Hose Suction Control**
- 2. Extension Tube Switch**
- 3. Floor Brush Pedal**
- 4. Combination Nozzle**
- 5. Hose Connector**
- 6. Dust Container Clasp**
- 7. Bin Release Button**
- 8. Cyclonic Filter**

- 9. Dust Container**
- 10. Dust Filter**
- 11. ON/OFF Button**
- 12. Cord Rewind Button**
- 13. Brush Clip**
- 14. Mains Plug**
- 15. Grill and Exhaust Filter**

Preparation Before Use

1. To connect the hose, insert the hose connector into the hose connection opening until you hear a “click” sound.

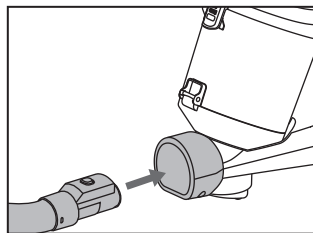

2. Connect the telescopic tube to the handgrip of the hose.

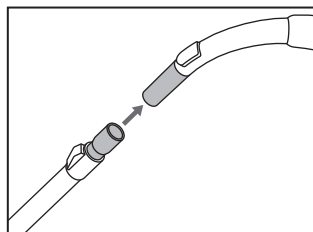

3. Extend the telescopic tube to a length you find most comfortable by pushing the button forward. The button is on the telescopic tube. Connect a nozzle / brush suitable for the floor type to be cleaned.

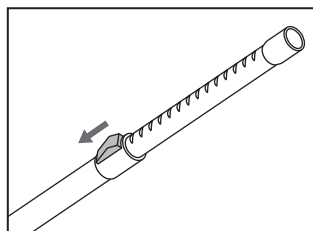

4. The hard floor brush can be used with the brush lowered (for carpet) or raised (for hard floor). You may also connect the nozzle to vacuum corners, slots or grooves (not included).

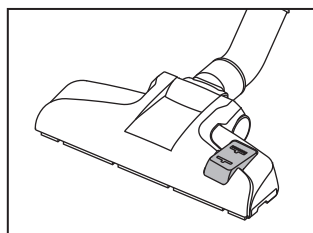

Operation

1. Hold the mains plug and pull the retractable mains cable out of the vacuum cleaner. Connect it to the mains socket.



The YELLOW mark indicates the ideal length to extend the cable. Do not extend the mains cable beyond the RED mark which indicates the maximum length.

2. Press the **ON/OFF** button on the top of the vacuum cleaner to turn it on.
3. To move the vacuum cleaner from room to room, you can unplug and carry it by either the handle or the handgrip. Never use the mains cable to pull the vacuum cleaner.

Powering Off and Storage

1. Press the **ON/OFF** button on the top of the vacuum cleaner to turn it off.
2. Unplug the mains cable from the mains socket.
3. Press the cord rewind button to rewind the retractable mains cable.
4. Detach the hard floor brush / nozzle from the telescopic tube.

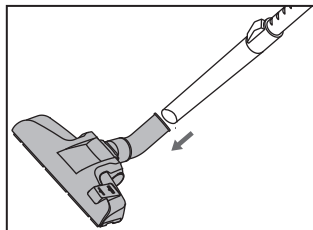

5. Pull the telescopic tube firmly to detach it from the hose.

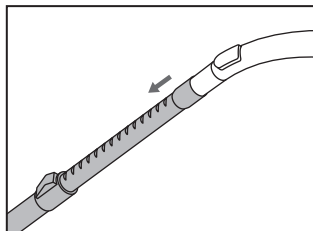

6. Press button on the hose connector to detach the hose from the unit.

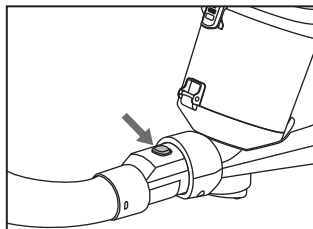

7. Place the floor brush on the brush clip at the back of the unit.

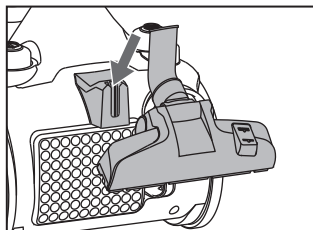

Emptying the Dust Bin



Ensure the vacuum cleaner is fully unplugged from the mains socket.

1. Press the release button at the top of the lid handle.

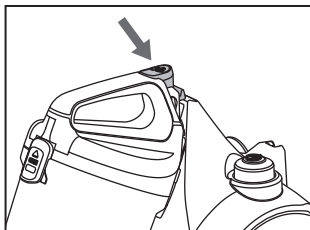

2. Lift the container up and remove it from the unit base.

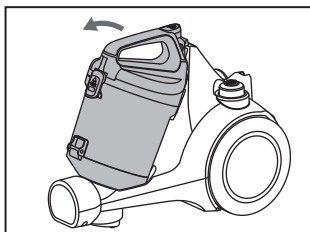

3. Press the release button at the back of the container to open the base cover.

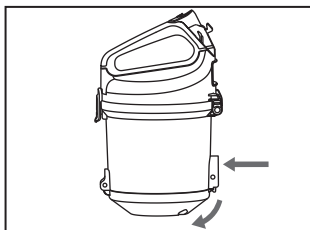

You might empty the dust container over a litter bin or litter bag to prevent small particles of dust from scattering around on the floor.

Cleaning the Filters in the Dust Container



Ensure the vacuum cleaner is fully unplugged from the mains socket.

1. After lifting up the container lid, remove the cyclonic filter (a) and the dust filter (b) from the dust container.

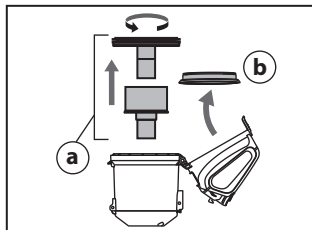

2. Clean the filters, and then dry them thoroughly before replacing back into the dust container.

Cleaning the Exhaust Filter



Ensure the vacuum cleaner is fully unplugged from the mains socket.

1. Remove the filter cover from the unit.

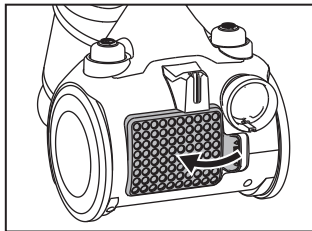

2. Remove the filter from the unit.

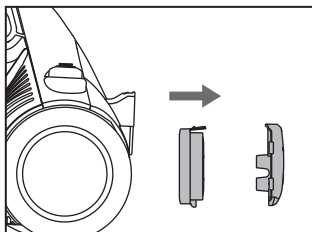

3. Wash the filter, and dry it thoroughly before replacing into the container.

Specifications

Model	C700VC18
Rating	220-240 V~, 50 Hz, 700 W, Class II
Dust bin capacity	1.2L

Features and specifications are subject to change without prior notice.

Currys.co.uk

All the support you need.

Whether it's a tech emergency or
you need plain good advice, we're
always on hand to help.

UK: 0344 561 1234

IRE: 1890818 575

Partmaster
CO.UK

Visit Partmaster.co.uk today for the easiest way to buy electrical spares and accessories.
With over 1 million spares and accessories available we can deliver direct to your door
the very next day. Visit www.partmaster.co.uk or call **0344 800 3456** (UK customers only).
Calls charged at National Rate.



The symbol on the product or its packaging indicates that this product must not be disposed of with your other household waste. Instead, it is your responsibility to dispose of your waste equipment by handing it over to a designated collection point for the recycling of waste electrical and electronic equipment. The separate collection and recycling of your waste equipment at the time of disposal will help conserve natural resources and ensure that it is recycled in a manner that protects human health and the environment.

For more information about where you can drop off your waste for recycling, please contact your local authority, or where you purchased your product.

DSG Retail Ltd. (co. no. 504877)
1 Portal Way, London, W3 6RS, UK

EU Representative

DSG Retail Ireland Ltd (259460)
3rd Floor Office Suite,
Omni Park SC, Santry, Dublin 9, Republic of Ireland